

Use the instructions in this Quick Start Guide as an overview to assemble, setup, and operate the Axiom 2x2 CNC Router. For detailed instructions on the assembly, setup, and use of this machine including important safety information, please read and understand the entire owner's manual.

### Step 1. Install legs and mount spindle to gantry arm.

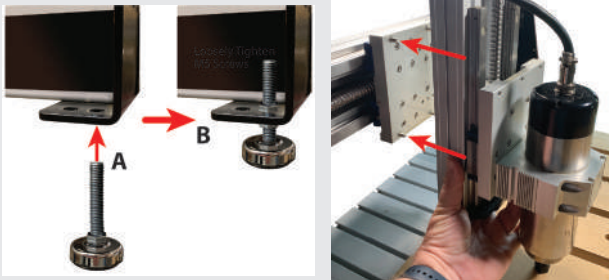

### Step 2. Vertically adjust spindle and tighten. Plug in X and Y servo cables to motors.

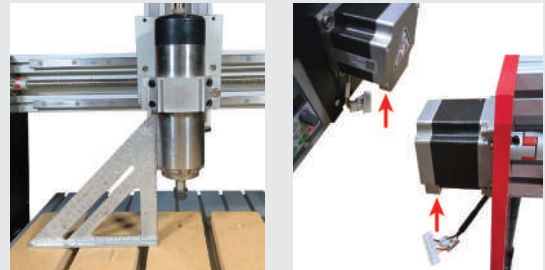

### Step 3. Connect to a 115V outlet and turn power switch on. Note: Not compatible with GFCI outlet.

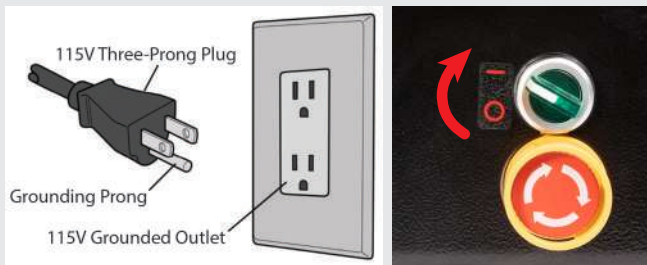

### Step 4. Install UCCNC software, UCCNC profiler, and Vectric VCarve on your laptop. These are found on the included USB or can be downloaded after scanning the QR code.



### Step 5. Connect laptop to the Axiom 2x2 using the included RJ45 cable.



### Step 6. Create a toolpath using the VCarve software. If you already have a created toolpath, proceed to Step 7.

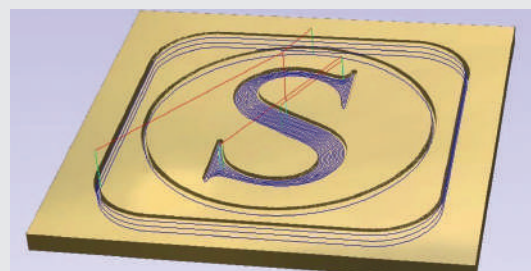

### Step 7. Load toolpath into the UCCNC software.

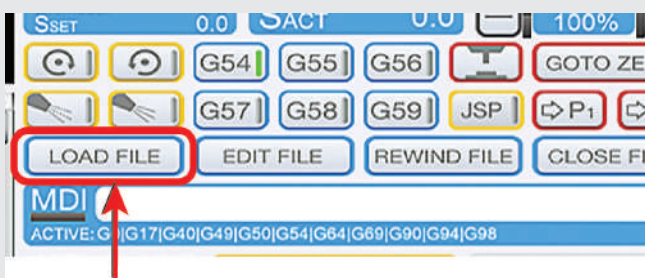

### Step 8. Start your project!

