

GENERAL SETUP

From main setup menu ⑤ To enter general setup



Optional Settings

Numeric Key	Setup Function
1	English UK
2	English US
3	Chinese
4	Danish
5	Spanish
6	French
7	More

Select more for other languages



- ① Selects Mill
- ② Selects Lathe
- ③ Selects Generic



- ① Selects axis 1 and axis 2
- ② Selects axis 1 and axis 3
- ③ Selects axis 2 and axis 3



- ① Enables the axis coupling function
- ② Disables the axis coupling function

Enable or Disable Functions

Numeric Key	Function
1	Tool Offsets
2	Vector
3	Taper Angle
4	Axis Summing
5	PCD
6	Line Hole
7	More
press key 7 for the options below	
1	Arc Contouring
2	Polar Co-ordinates
3	Skew
4	Data Logging
5	Sub Datums

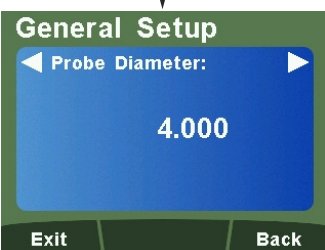

Enter the probe diameter using the numeric keys in inch's or millimeters

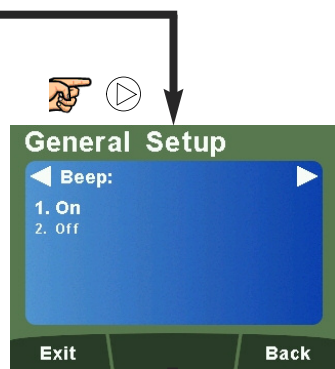

Optional Settings

- ① Beep on
- ② Beep off

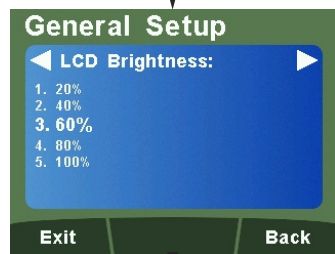

- ① Selects 20%
- ② Selects 40%
- ③ Selects 60%
- ④ Selects 80%
- ⑤ Selects 100%

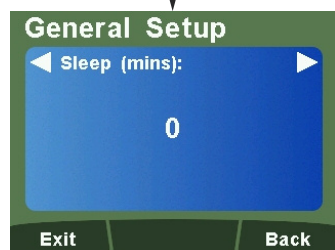

Enter using the numeric keypad the number of minutes before the sleep function operates.

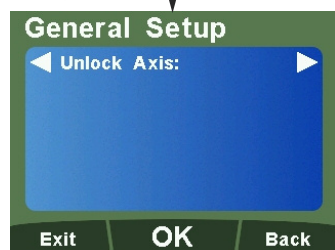

See full manual on web site for more details



See full manual on web site for more details

- Back To return to the previous menu
- OR
- Exit To return to normal operation

Newall Measurement Systems, Ltd: Technology Gateway · Cornwall Road · South Wigston · Leicester · LE18 4XH · England

Tel: +44 (0) 116 264 2730 · Fax: +44 (0) 116 264 2731

Newall Electronics, Inc: 1778 Dividend Drive · Columbus · OH 43228 · USA · Tel: +1 (614) 771 0213 · Fax: +1 (614) 771 0219 · Website: www.newall.com

NOTE: Newall Measurement Systems Ltd. reserves the right to change the specification without notice.



023-81450-UK/0

NEWALL DP1200 Quick Start up Guide

For the complete manual please download from: <http://newall.com> , Click technical Support to access the download page.

Warnings

The mains supply is connected into a switch mode power supply (separate from your DP1200) via a detachable supply cord supplied. If another supply cord is used, it must have fitted a C5, 10A, EARTHED mains connector with a cord rated for at least 10A.

If a mains plug is not already fitted to the supply cord or is of the wrong type, then a suitable EARTHED plug should be used which complies with the relevant specifications for plugs and socket-outlets.

Encoder inputs 1, 2 and 3 can be used with Newall Spherosyn and Microsyn analogue encoders. Encoder input 4 can be used with Spherosyn/Microsyn or RS422 (5v TTL) **dependant on model.**

The power supply must be disconnected before opening the unit and repairs should be completed by qualified personnel.

Turn off the power by disconnecting the power supply connector, before you connect the encoder(s)

Technical Specification

Environmental

Operating Temperature -10°C to 50°C
Storage Temperature -20 to 70°C

Environmental Conditions - IP40 (Stand Alone)
 IP54 (Panel Mount)

Relative Humidity - maximum 95% for temperature up to 31°C

Electrical

EU Directive 73/23/EEC (Low Voltage Directive)
 BS EN 55022:1998 Class B
 BS EN 55024:1998

Input to External Switch Mode Power Supply Unit (Supplied)
 100-240V (47-63Hz)

External
 Output voltage 15VDC

Input Voltage to DP1200
 15-24VDC ±10%

Conforms to Low Voltage Directive

Connections

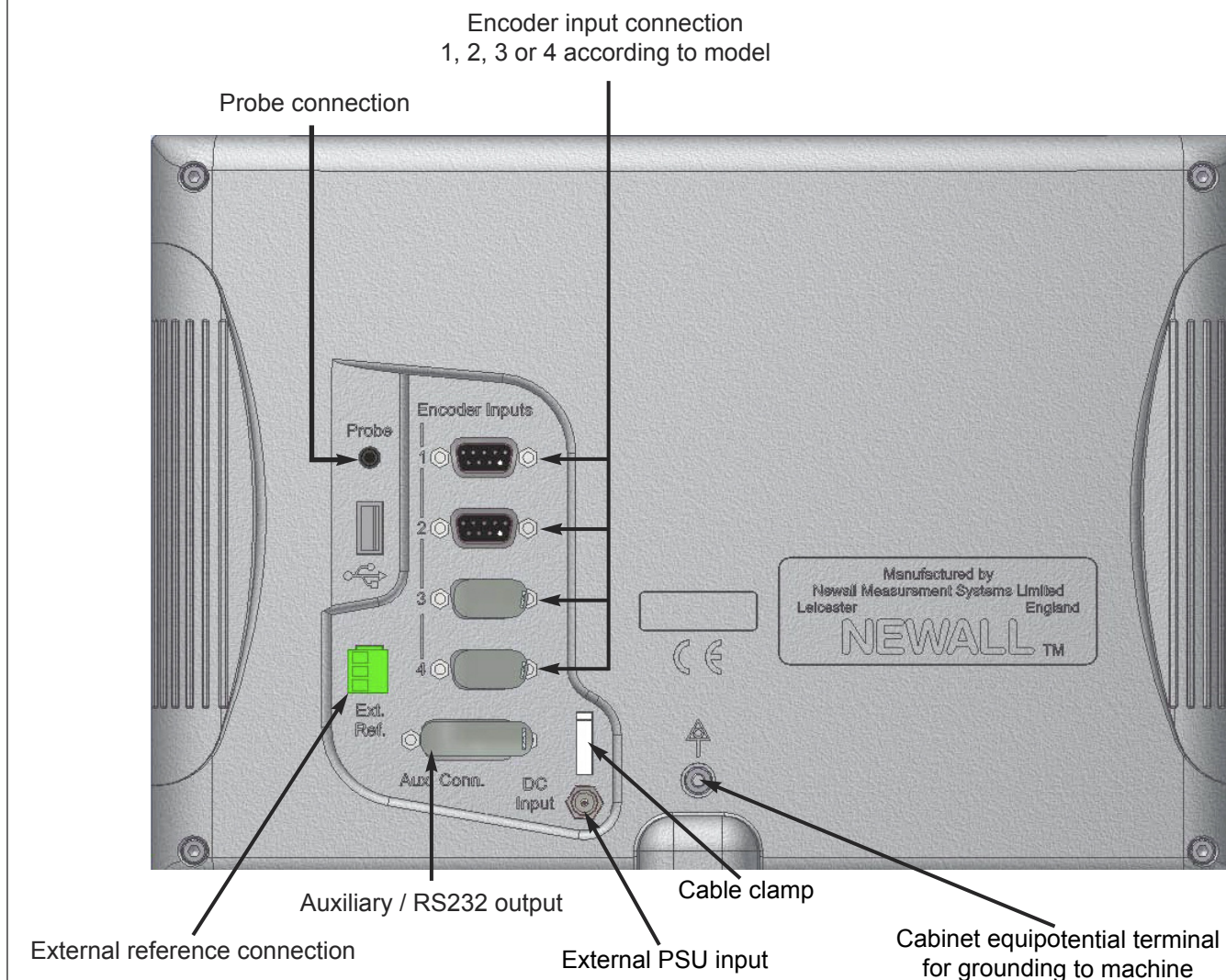

Understanding the Keypad

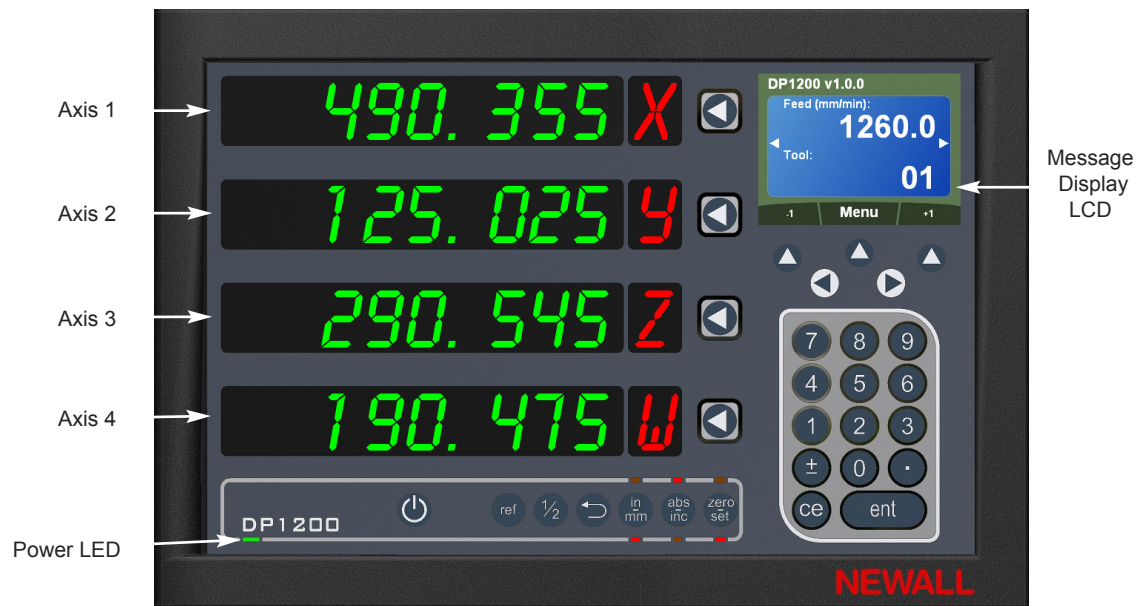

	Axis Selection Key		Digifind / Reference
	Numeric Keys		Switches between Zero and Axis Preset modes
	Enter Key		Switches between Absolute and Incremental modes
	Clear Numeric Entry		Switches between Inch and mm display
	Centre Find		Soft Keys (left, middle & right)
	Undo Key		Navigation Keys
			Sleep Key

Zero an Axis in Zero Mode

Ensure DP1200 is in Zero Mode of Axis 1, 2, 3 or 4

Zero an Axis in Set Mode

Ensure DP1200 is in Set Mode of Axis 1, 2, 3 or 4

Preset an Axis

Ensure DP1200 is in Set Mode =

ENTERING SETUP

AXIS SETUP (ANALOGUE)

Legend Setup

To setup the 1st axis

To setup the 2nd axis

To setup the 3rd axis

To setup the 4th axis

Set the legend of the axis to a character from the table

Key	1 st Press	2 nd Press	3 rd Press	4 th Press	5 th Press
0	0	N/A	N/A	N/A	N/A
1	X ¹	Y ¹	Z ¹	1	N/A
2	A	B	C	2	N/A
3	D	E	F	3	N/A
4	G	H	I	4	N/A
5	J	K	L	5	N/A
6	M	N	O	6	N/A
7	P	Q	R	S	7
8	T	U	V	8	N/A
9	W	X	Y	Z	9

AXIS SETUP (ANALOGUE)

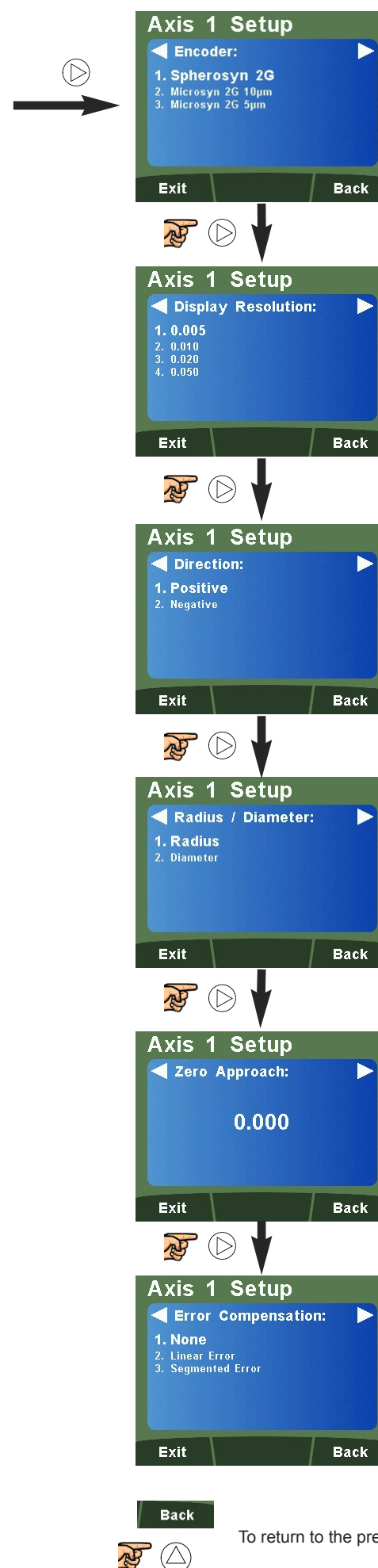

Default Settings

Spherosyn 2G

Encoder type must match to encoder in use, or the DP1200 will not measure correctly.

Optional Settings

- Selects Spherosyn 2G
- Selects Microsyn 2G (10µm)
- Selects Microsyn 2G (5µm)

- | | | |
|--------------|--|--------------------------|
| | Spherosyn 2G & Microsyn 2G (10µm) | Microsyn 2G (5µm) |
| 5µm | Selects 0.005 (5µm) | Selects 0.001 (1µm) |
| 0.005 | Selects 0.010 (10µm) | Selects 0.002 (2µm) |
| 1µm | Selects 0.020 (20µm) | Selects 0.005 (5µm) |
| 0.001 | Selects 0.050 (50µm) | Selects 0.010 (10µm) |

This is the resolution that will be used in the axis display

- Positive**
- Selects positive
 - Selects negative

Changes the direction of travel from positive to negative or negative to positive.

- Radius**
- Selects radius
 - Selects diameter

When set as a lathe the 1st axis is automatically set to the diameter setting.

0.000 User defined, use numeric keypad to enter value in inches or millimeters

This setting provides a visual indication when the set zero limit is passed.

See full manual on web site for more details

Back To return to the previous menu